



JTGK-600FS Graphite Machining Center

Product descriptions and features

■ Features

- Suitable for graphite dry cutting
- Box structural design and unique damping characteristics, superior dynamic machining performance
- 3D contour accuracy satisfies the machining of hot bending glass mold
- Full closed loop control for higher contour accuracy (optional)
- High efficiency, high precision
- High rigidity, high speed motorized spindle to improve the surface finish quality

■ For Material

Graphite

■ Applied Range

Graphite fixture, electrode



KEJIE website



KEJIE wechat

Parameters

Item	Parameter
Working area X/Y/Z	600/500/250mm
Work table size	630x500mm
Max load of table	300kg
Spindle power Max spindle speed	4.0kw/32000rpm
Rapid traverse rate	18m/min
Cutting feed rate	10m/min
Positioning accuracy	0.008mm 0.005mm [full closed loop]
Repeatability	0.004mm 0.003mm [full closed loop]
Weight	4000kg
Machine dimension	1800x2100x2400mm
Power supply	3-PH AC380V ±5% 50Hz

Standard Accessories

- High speed CNC controller
- High speed spindle
- AC servo motor
- Precision ball screw and guide rail
- Tool setting sensor
- Hand Wheel
- Spindle cooling system

Optional Accessories

- Automatic tool changer
- Dust collector
- Voltage stabilizer
- Air drier
- Probe

Machine dimension

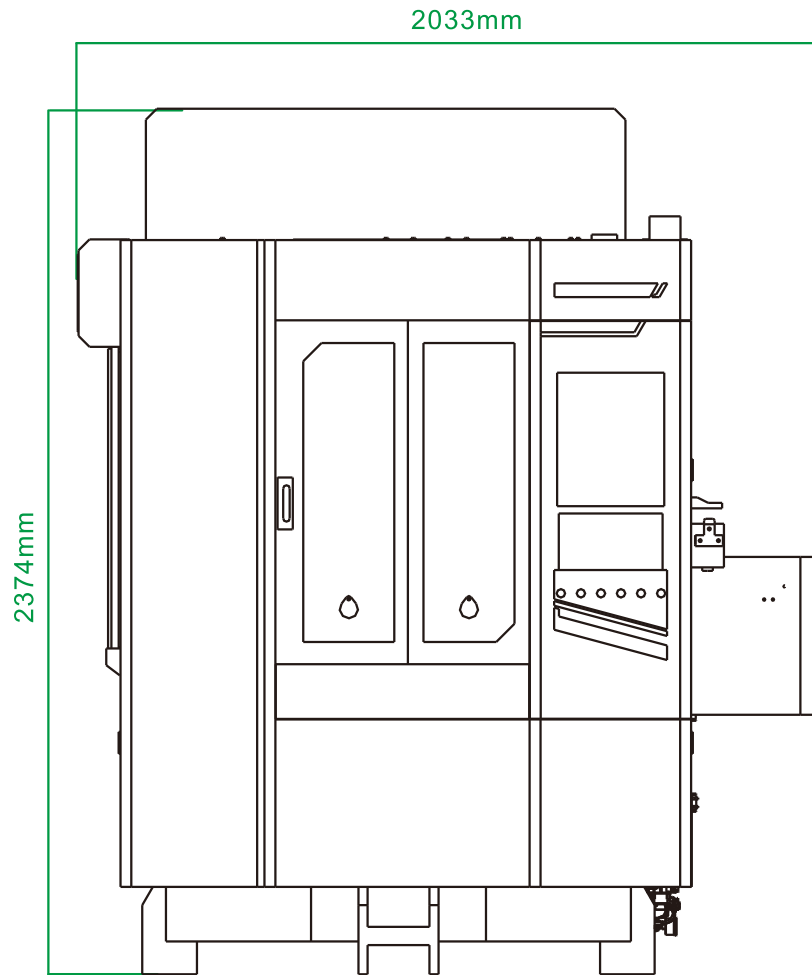

Front

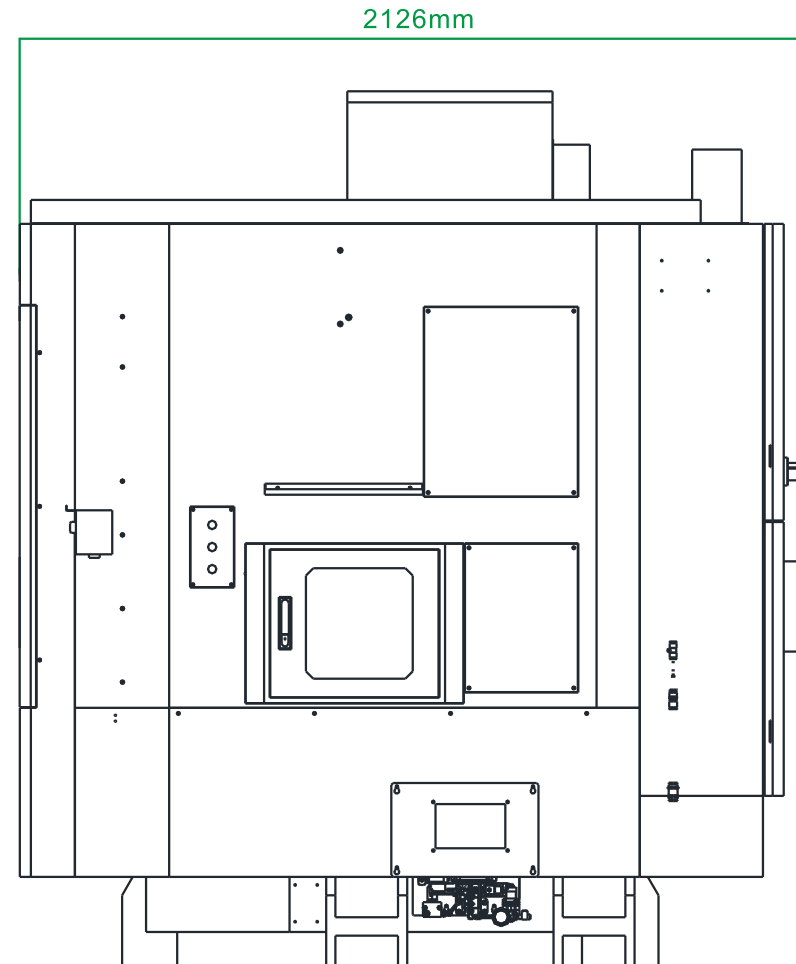

Left