



JTGK-600F

High Speed Engraving and Milling CNC Machine

Product descriptions and features

Features

- User-friendly, easy to operate and manage
- ATC with larger tool capacity, multitasking
- Particularly suitable for batch parts machining

For Material

Aluminum alloy, magnesium alloy

Applied Range

Equipment manufacturing, parts, mold, shiny chamfering on the shell of consumer electronics, etc



KEJIE website



KEJIE wechat

Parameters

Item	Parameter
Working area X/Y/Z	600/500/300mm
Work table size	630x500mm
Max load of table	300kg
Spindle power Max spindle speed	4.0kw/32000rpm or 5.5kw/30000rpm or 6.0kw/32000rpm
Rapid traverse rate	18m/min
Cutting feed rate	12m/min
Positioning accuracy	0.008mm
Repeatability	0.004mm
Weight	4000kg
Machine dimension	1900x1640x2490mm
Power supply	3-PH AC380V ±5% 50Hz

Standard Accessories

- High speed CNC controller
- High speed spindle
- AC servo motor
- Precision ball screw and guide rail
- Tool setting sensor
- Hand Wheel
- Spindle cooling system

Optional Accessories

- Automatic tool changer
- 4th axis
- Voltage stabilizer
- Oil mist collector
- Probe

Machine dimension

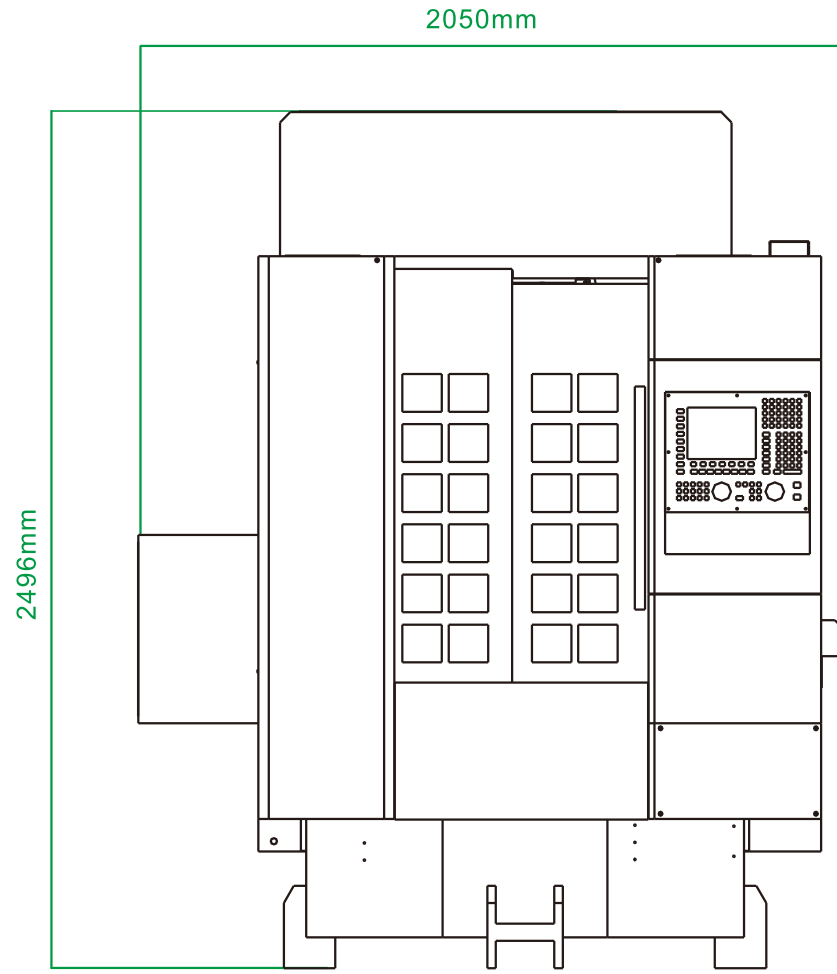

Front

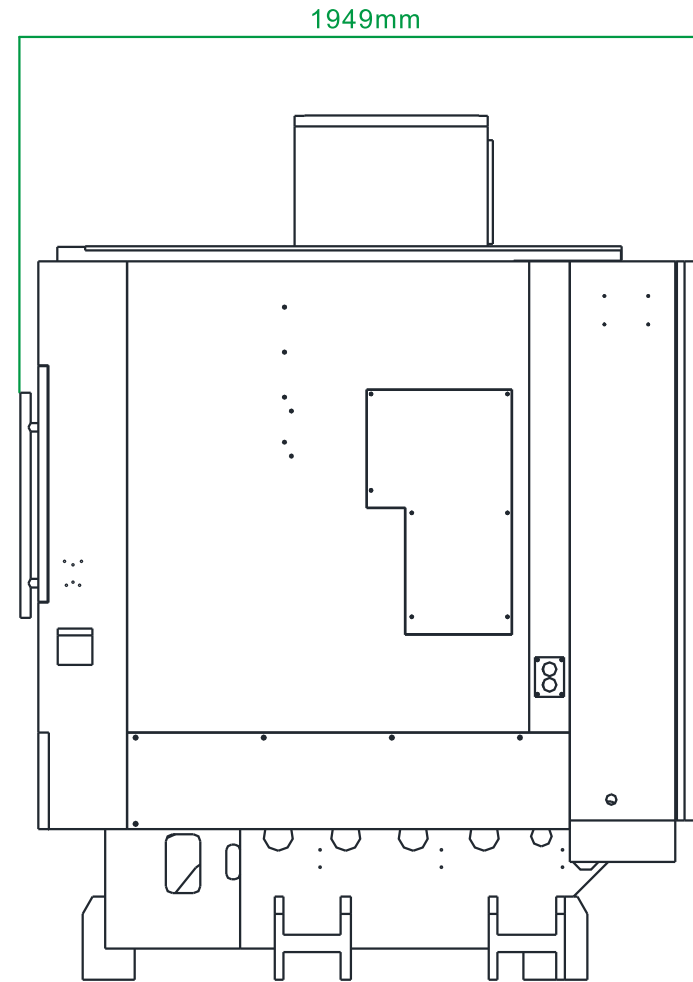

Left